

GCP PRODUCT OFFER

Building the World Better

Through high-performing, sustainable
construction products

PREPRUFE® 120S Membrane

Pre-applied waterproofing membrane that bonds integrally to poured concrete for use with below foundation slabs and below ground cast-in-place walls on confined sites where single-sided formworks will be used.

Product Description

GCP PREPRUFE® 120S pre-applied waterproofing membrane is a unique composite sheet comprised of a thick HDPE film, pressure sensitive adhesive and weather resistant protective coating.

PREPRUFE® 120S membrane forms an integral adhesive bond to poured concrete. This integral bond is specifically designed to provide a robust barrier to water, moisture and soil contamination, and prevents both the ingress and lateral migration of water.

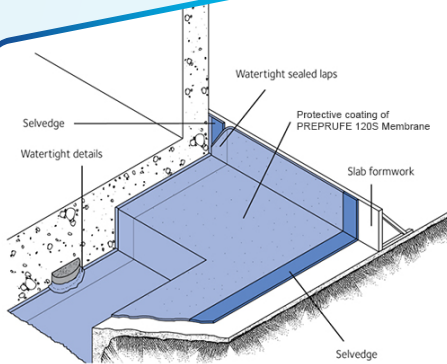

Drawings are for illustration purposes only.
Please refer to gcpat.com for specific application details.

PREPRUFE® DLM

Mono-component environmentally and EHS friendly detailing liquid membrane for use with GCP Applied Technologies waterproof membranes.

Product Applications

PREPRUFE® DLM is a damp-concrete tolerant and monocomponent liquid membrane (EHS Friendly), which does not require mixing and cures using air moisture. PREPRUFE® DLM is caulk applied, and is supplied in 600ml sausages. Coverage is approx. 2.5 litres per m² at 2.5 mm thickness.

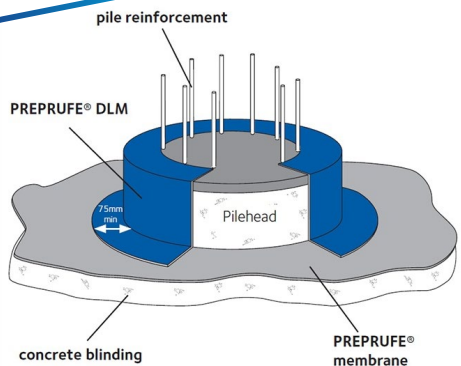

Details shown are typical illustrations only and not working drawings. For assistance with working drawings and additional technical advice please contact GCP Technical Services.

BITUTHENE® 3000 and BITUTHENE® Low Temperature Membranes

For above grade plaza and parking decks and below grade basements, tunnels and other subterranean applications.

Product Description

BITUTHENE® 3000 and BITUTHENE® Low Temperature Membranes are self-adhesive, rubberized asphalt/polyethylene waterproofing membranes for elevated plaza and parking decks and below grade basements, tunnels, and other subterranean applications.

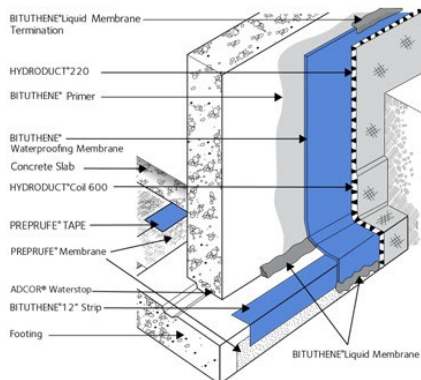

Drawings are for illustration purposes only.
Please refer to gcpat.com for specific application details

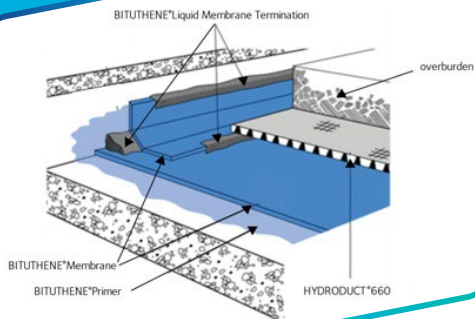

GCP Applied Technologies' ("GCP") BITUTHENE® 3000 and BITUTHENE® 3000 Low Temperature Membranes combine a robust, flexible, pre-formed high performance, cross laminated, HDPE carrier film with a tacky, self-adhesive rubberized asphalt compound specifically designed to adhere to cured concrete surfaces.

Safety and Handling Information

Users must read and understand the product label and safety data sheet (SDS) for each system component. All users should acquaint themselves with this information prior to working with the products and follow the precautionary statements. SDSs can be obtained by contacting Andries Janse van Rensburg.

Email: andries.jansevanrensburg@saint-gobain.com
Mobile: +27(0) 82 855 3385

BETEC Wind UHD

High strength grout with strength class C90/105.

Product Description

BETEC Wind UHD is a cement based, volume stable grout with high initial and final strength development with final strength class of C90/105 and tested fatigue resistance according to Model Code 2010, Model Code 2020 for dry conditions and Eurocode 2 part 2 (2010).

BETEC Wind UHD stands out by controlled volume expansion and offers maximum durability and applicability.

Areas of Application

All grouting applications where superior applicability, high performance and durable connections are required:

- Structural connection of onshore-wind energy.
- Assembly of wind energy towers and anchoring in the foundation.



BETEC Wind UHS

High strength grout with strength class C100/115.

Product Description

BETEC Wind UHS is a cement based, volume stable grout with high initial and final strength development with final strength class of C100/115 and tested fatigue resistance according to Model Code 2010, and EN 1992-2, part 2 concrete bridges. BETEC Wind UHS stands out by controlled volume expansion and offers maximum durability and applicability.

Areas of Application

All grouting applications where superior applicability, high performance and durable connections are required:

- Structural connections of onshore wind turbine foundations.
- Segment assembly for concrete wind towers.

BITUTHENE® 5000

Composite membrane incorporating high performance moisture and water-resistant rubberised asphalt with tough, puncture and heat-resistant polypropylene reinforcing mesh. Specially developed for use under a hot applied asphalt concrete wearing course.

Product Description

BITUTHENE® 5000, also known as Heavy Duty Bituthene, is a waterproofing material incorporating high strength, heat-resistant mesh embedded in a layer of self-adhesive rubberised asphalt. It is supplied in rolls interwound with special release paper which protects the adhesive surface until ready for use and a lows easy handling during installation.

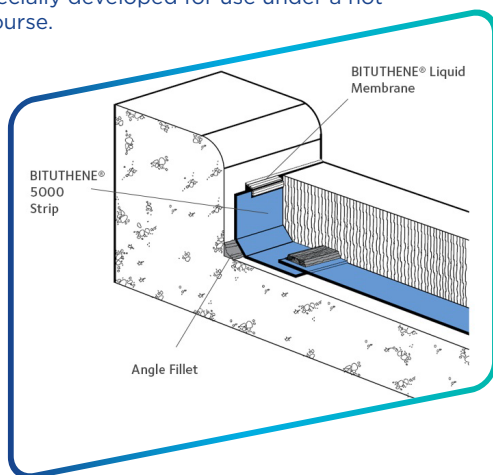

ELIMINATOR® Bridge Deck Waterproofing

ELIMINATOR® offers distinct advantages to all key stakeholders who rely on these bridges for a safe, reliable means of travel and commerce.

Protection you can trust

Waterproofing highway bridges is critical to their structural integrity and lifespan. Fault in product performance or application can be costly and, at worst, devastating. Eliminate risk and return to service faster with GCP's proven waterproofing system and best-in-class technical support.

The ELIMINATOR® System

Pavement Overlay: Asphalt/Concrete

Tack Coat: Modified Bitumen Bond Coat SA 1030

(Optional) ELIMINATOR® Membrane (2nd Coat) Grey Coat

ELIMINATOR® Membrane (1st Coat) Yellow Coat

Concrete or Steel Primer/Corrosion Inhibitor

Bridge or Deck Substrate

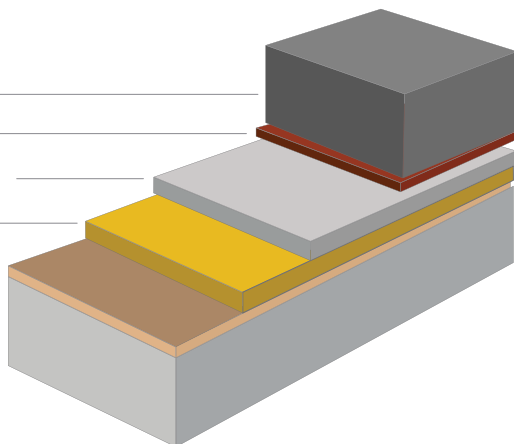

ADCOR® 500S

Thick sectioned, conformable, hydro-expansive waterstop for preventing water entry through joints in concrete sub-structures.

Product Description

ADCOR® 500S is a conformable, swellable polymer/butyl rubber waterstop strip that expands in contact with water. When fully encapsulated by poured concrete, the expansive forces form a seal against concrete faces. The seal resists hydrostatic pressure, stopping water from entering sub-structures.

ADCOR® is a unique product that has been specifically developed to provide higher performance than conventional bentonite or swellable rubber waterstops. Superior performance arises from:

- Controlled, reproducible, volumetric expansion.
- Cohesive strength maintained after volumetric expansion.
- Malleable and plastic, enabling easy application to a variety of concrete profiles.

GCP can also uniquely provide continuity of swellable waterstops at construction joint/movement joint intersections.

Adcor 500S at floor/wall joint

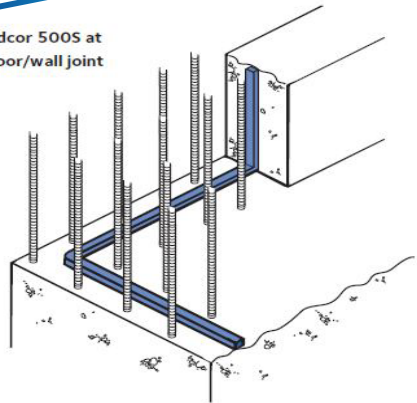

Details shown are typical illustrations only and not working drawings. For assistance with working drawings and additional technical advice please contact GCP Technical Services.

Product Advantages

- Controlled volumetric expansion - reduces risk of concrete spalling.
- Conformable – can be installed onto a variety of irregular substrates.
- Retains cohesive strength at both original and expanded volume.
- No need for protective steel mesh.
- Resists at least 6 bar (60 m) hydrostatic pressure.
- Volumetric expansion min 100% in cement water.
- Simple overlap jointing on site.
- Reproducible swell after wet-dry cycling.
- Can be easily joined to GCP PVC waterstops at movement joints.
- Unaffected by freeze/thaw cycling.

SWELLSEAL® Mastic

Caulk-applied, one-component, hydro-swelling mastic for sealing smooth and rough construction joints and pipe penetrations.

Product Description

SWELLSEAL® Mastic is a one-component, polyurethane-based, solvent free, hydros swelling mastic, supplied in cartridges and aluminium sausages, for the sealing of construction joints and around pipe penetrations.

SWELLSEAL® Mastic cures and swells in the presence of moisture. Curing time depends on temperature and humidity conditions, i.e. curing time will reduce if RH and Celsius degrees are higher. SWELLSEAL® Mastic will become firm in 24-36 hours. Performance is not affected by the curing time.

Field of Application

SWELLSEAL® Mastic is used for:

- Sealing rough and smooth construction joints of in-situ cast concrete.
- Sealing joints between pre-cast segments (e.g. manholes, box culverts, cable ducts and pipes).
- Sealing around steel H-beams.
- Sealing between rough surfaces (e.g. slurry walls) and concrete slabs.
- Bonding strip sealants to rough surfaces.
- Sealing around bolt spacers and void formers.
- On secant pile walls.

Product Advantages

- Solvent free.
- SWELLSEAL® Mastic can be applied to concrete, PVC, HDPE, steel, etc.
- The excellent filling and adhesion properties of the product provide a first line filling of cracks and voids, even on lightly humid, smooth or rough surfaces.
- In contact with water SWELLSEAL® Mastic will expand to about 350% of its original volume.
- Flexible system, which adapts to the irregular surface of the substrate.
- Easy application with standard caulking gun.
- Durable: will exceed the construction's life.
- Has a good all-round chemical resistance(*).
- Can resist petroleum, mineral and vegetable oils and greases.
- SWELLSEAL Mastic is approved for contact with potable water.

CHRYSO SOUTHERN AFRICA

Gauteng (Head Office) • 26 Malcolm Moodie Crescent • Jet Park • 1469

Tel: +27 (0) 11 395 9700

za.chryso.com

Unit D6 • 7 & 8 Connaught Park
Entrance 2 • Riley Street • Beaconvale
Cape Town • Tel: +27 (0) 21 928 1660

Unit 3 • 14 Travertine Crescent
Briardene • Durban
Tel: +27 (0) 31 564 0325

86 Fritz Stockenström Street
New East End • Bloemfontein
Tel: +27 (0) 51 432 0036

C/O Willow Road and Leadwood
Crescent • Fairview • Gqeberha
Tel: +27 (0) 41 391 6000

CHRYSO EASTERN AFRICA

Kibhara Centre • Mombasa Road • Nairobi • Kenya

Tel: +254 725 041 526

ke.chryso.com

For more info contact

Andries Janse van Rensburg

Business Development Manager - Specialty Building Materials

Mobile: +27(0) 82 855 3385

Email: andries.jansevanrensburg@saint-gobain.com



SAINT-GOBAIN
CONSTRUCTION CHEMICALS

After Saint-Gobain's acquisition of both Chryso and GCP, Chryso now supplies GCP products, expanding our portfolio with advanced solutions for concrete and construction. This enables Chryso to offer more integrated, high-performance technologies that enhance durability, efficiency, and innovation across projects.